



# సమ్మక్క సారక్క ఎవరెస్ట్ - 2

@ కొలనుపాక, యాదాద్రి

(తక్కువ పెట్టుబడి, ఎక్కువ భూమి)

మీ చిన్నారుల బంగారు భవిష్యత్తుకు  
బంగారం కంటే, డిపాజిట్ల కంటే, షేర్ల కంటే లాభదాయకమైన పెట్టుబడి



ఇంటి స్థలముతో పాటు 4 మలబారు వేప చెట్లు  
తెలివైన పెట్టుబడికి విలువైన రాబడి

KOMARAVELLI MALLANNA



JAIN MANDIR



SOMESHWARA TEMPLE



## LOCATION HIGHLIGHTS

- \* Beside KYKK 120 Feet Road
- \* Keesara, Yadagirigutta, Kolanpaka, Komeravelli (Yadadri Tourisam Hub)
- \* Very Near to Kotilingala Temple & India's Biggest Jain Mandir Kolanpaka
- \* Near to Kolanupakka Mini Tankbund
- \* 5 Min's Drive from Warangal National Highway
- \* 5 Min's Drive to Aler Rly. Station & Bus Station
- \* 15 Min's Drive to Yadagiri Gutta (Yadadri)
- \* 15 Min's Drive to Komaravelli Mallanna Temple
- \* Beside 100Feet Siddipet Highway Road
- \* Near to Engineering colleges, Schools
- \* Siddipet Aler Janagam Industrial Corider
- \* Very Good Development Area & Fastest Developing Tourism Place



MINI TANK BUND

**SPOT  
REGISTRATION**

## PROJECTS HIGHLIGHTS

- \* Clear Title
- \* Spot Registration
- \* The Entire Layout Designed as Per Vasthu
- \* 30 Feet Wide Roads
- \* 24 x 7 Security
- \* Gate with Fencing
- \* Each Plot 4 Guava Trees

PLAN SHOWING LAYOUT PLAN IN SY.NO : 1768/బ/2, 1768/ఉ , SITUATED AT : KOLANUPAKA VILLAGE, ALAIR MANDAL, YADADRI BHONGIR DIST T.S.

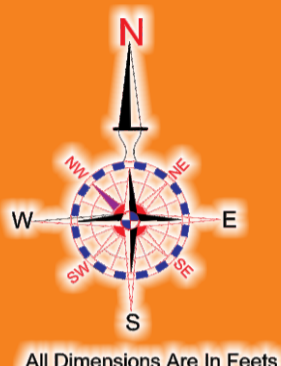
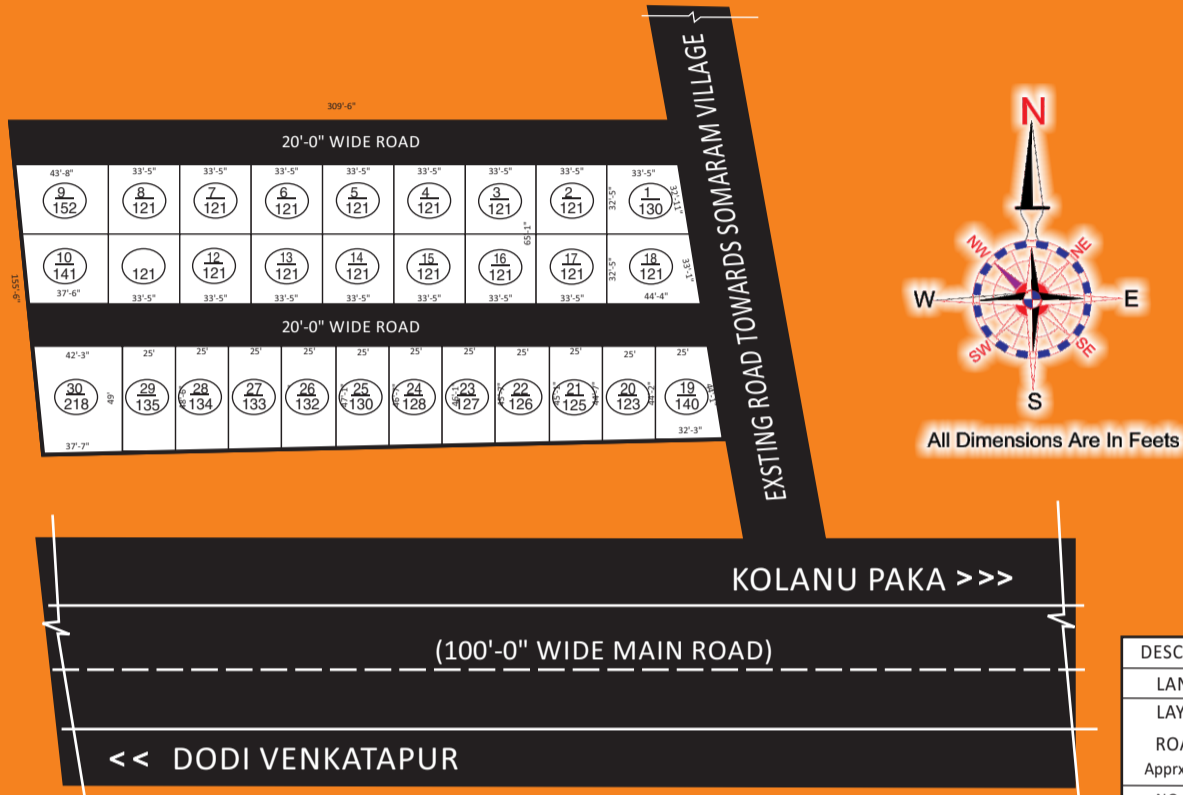

All Dimensions Are In Feet

DESCRIPTION :	
LAND ANALYSIS	Syd
LAYOUT AREA	5324
ROADS AREA	1407
Apprx. PLOTTED AREA	3917
NO OF PLOTS	30

- \* Northeast Corner 200 Rupees Extra Per Sq. Yd
- \* Extra Other Corner 150 Rupees Extra Per Sq. Yd.
- \* East Phase 100 Rupees Extra per Sq.Yd
- \* The Cost is directly proportionate according to the size of the plot.
- \* Registration charges will be borne by the member

**PAYMENT MODE**

**121 SQ. Yrds (1 Gunta)**

**Booking Amount : 20,000/-**  
**Allotment : 1,00,000/-**  
**EMI Allotment : 1,50,000/-**  
**Remaining Balance Should be Paid in 45 Days**



**SNSA DEVELOPERS Pvt. Ltd.**

Plot No 44, Street No 1A, Mamatha Nagar, Nagole Cross Roads, Beside Supraja Hospital, Nagole, Hyderabad, Telangana 500 068.

For Further Details Contact :

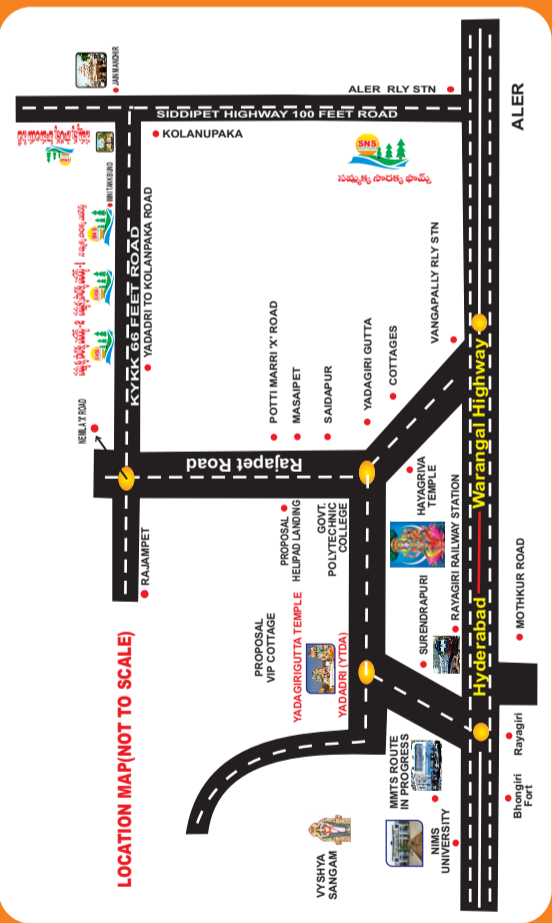

All Credit and debit cards are accepted Cheque / DD's are to be draw in favour of SNSA Developers Pvt. Ltd.